

Features

- Completely fire resistant
- Fungus and moisture resistant
- Easily cleaned
- Virtually seamless
- Used throughout the world for 25 years
- Can be fabricated to any shape room
- Highly resilient
- Will never need to be replaced
- Manufactured specifically for each application

For use in

- Correctional facilities
- Police stations
- Court houses
- Remand centres
- Special purpose health facilities

For the protection of

- Self harm patients or inmates
- Violent detainees
- Alcohol or drug affected detainees

Partial Installation List

- Brisbane City Watch House – Australia
- Wolston Correctional Centre – Australia
- Long Bay Correctional Centre – Australia
- Changi Prison – Singapore
- Pokok Sena Prison – Malaysia
- Pago Pago Hospital – American Samoa
- Mount Joy Prison – Ireland
- Clover Hill Prison – Ireland
- Kilkenny Hospital - Ireland
- Nanterre Police Station – France
- Mason Clinic – New Zealand

Many Government agencies nominate Gold Medal Safety Padding “by name”.

HOW TO CARE FOR A GOLD MEDAL SAFETY PADDING INSTALLATION

Whenever a cell has been used, a visual check must be carried out to identify any damage that may have been inflicted during its occupation. This must then be attended to before it is used again to prevent the possibility of serious damage.

Gold Medal Safety Padding can be hosed off, washed with detergents and scrubbed with a nylon type brush, without affecting its performance.

INSTALLATION

To ensure the quality and integrity of Gold Medal Safety Padding is maintained, installers must have undertaken specific training and achieved “Approved Installer Classification”.

REPAIRS

A standard and easy to follow set of instructions is left at each installation with a repair kit. This allows the repairs to be carried out by on site maintenance crews cutting down on time and cost dramatically.

FIRE CERTIFICATION

Gold Medal Safety Padding is completely Fire Resistant and Self Extinguishing. Stringent Fire Testing has been conducted and Certification issued in the following Countries. These test results are available On Request and have been used by various other organisations and Countries as a bench mark.

Australia • United States • United Kingdom
Ireland • New Zealand



Thank you for your interest in Gold Medal Safety Padding. Should you require any further assistance or information, please do not hesitate to contact us.

P +61 (0) 419 715 787 **F** +61 (0) 7 3276 7540

E martin@goldmedalsafetypadding.com.au

W www.goldmedalsafetypadding.com.au

PO Box 1165, Milton QLD 4064, Australia

virtually
seamless

highly
resilient



A tough, resilient
padding system
providing
maximum safety

... with minimal maintenance



Thank you for your
interest in Gold Medal
Safety Padding.



Gold Medal Safety Padding can be adapted to fit any style of room. Standard or split doors, cameras, intercoms, waste grilles or sprinkler outlets, can all be incorporated within this product.



For those rooms that require minimal protection Gold Medal Safety Padding can be applied to floors or beds only. This will provide a safe environment for those not classed at risk of self harm.



ABOUT GOLD MEDAL SAFETY PADDING

Gold Medal Safety Padding has been used for Seclusion Rooms in the United States and around the world for the past 25 years and is the preferred product in all new facilities. It is used extensively throughout Police, Correctional and Medical Institutions for the safe keeping of those persons who may through drug or behavioural problems are assessed to be at risk of causing harm to themselves or be destructive to their surroundings.

Gold Medal Safety Padding is a specially compounded synthetic resinous material, which is poured onto a strand board and once cured, is sectioned into 2.4 x 1.2 metre sheets.

The wall panels incorporate two compositions with the bottom layer providing the softer component allowing compression and the top layer providing the strength and protection against serious damage.

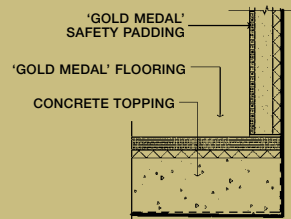

The floor pads are manufactured to ensure protection is still provided but can be manufactured to suit a number of different situations. Seams and fixing holes are filled with a resin compound and once cured are sanded and painted with Gold Medal urethane based paint. This provides a virtually seamless finished surface.

Gold Medal Safety Padding is highly resilient and has a smooth non slip surface, is completely fungus resistant, water resilient and easily cleaned.

ADVANTAGES

Historically vinyl, taraflex or canvas has been used for Seclusion Rooms, however if one small corner, seam or thread is exposed, an inmate or patient can cause severe damage which can cost many thousands of dollars to repair and render the room unusable for long periods. These products can also be used to inflict self harm resulting in severe injury, or worse.

The major advantage of Gold Medal Safety Padding is its strength and resilience to damage. While it is not immune to being picked or bitten, it is highly unlikely a complete wall or panel can be destroyed. Installation is an important factor with areas that may be subject to attack being fitted with the stronger floor pad material. Small areas of damage can be repaired by on site maintenance crews within 24 hours. This provides significant cost saving associated with the actual repair and length of time a room is out of commission.

AVAILABLE WORLDWIDE

Gold Medal Safety Padding is now available around the world through a network of carefully selected agents. This has resulted in increased awareness of the advantages of using Gold Medal Safety Padding and the improved safety and hygiene for patients and prisoners. There is also a significant improvement in maintenance issues and virtually no loss of usable cell time.

For details of the closest agent please contact martin@goldmedalsafetypadding.com.au

SAFE USE OF GOLD MEDAL SAFETY PADDING

Whenever a person is placed in a Seclusion Room they should have undergone a complete body search and not have any items on them that can be used to cause damage to the material such as belts, shoes etc. Ultimately they would be placed in the room in only undergarments and a gown.